

ELEVATION

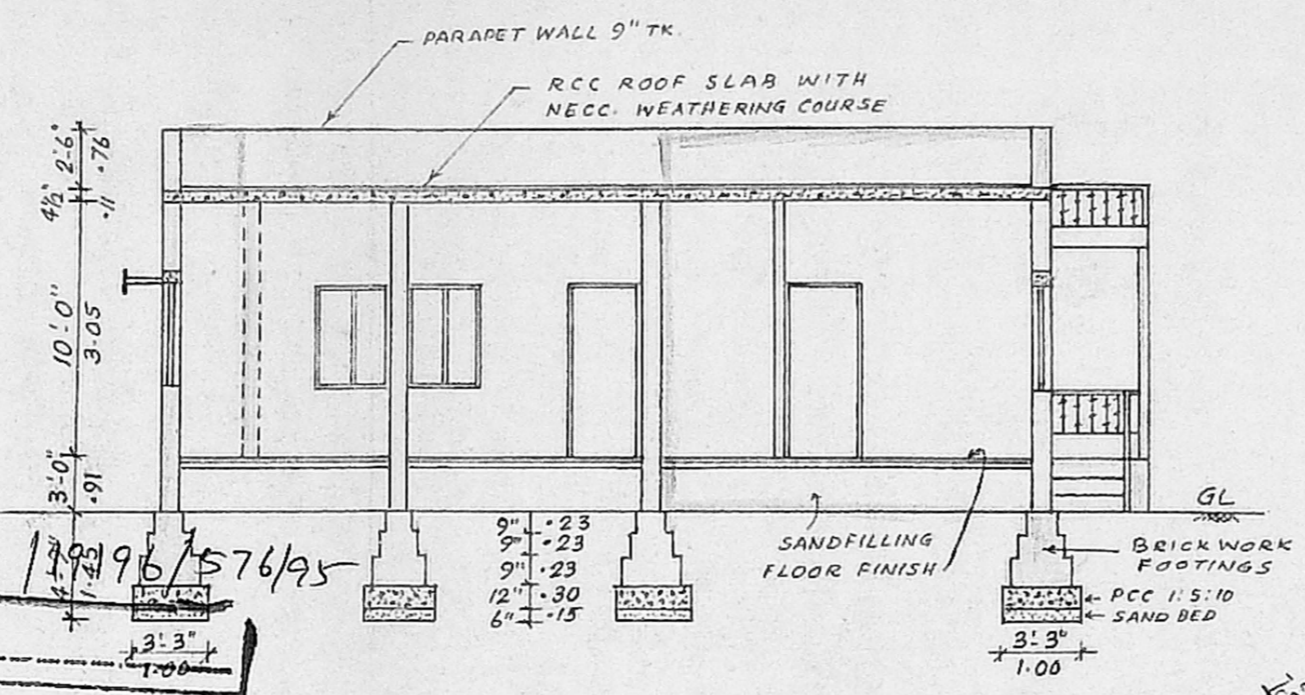

SECTION ON 'AB'

SEPTIC TANK DETAILS

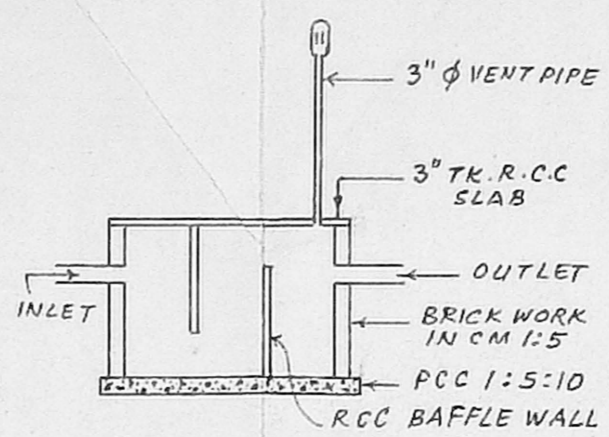

SECTION ON 'XY'

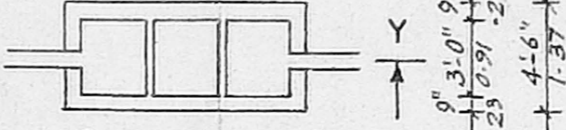

PLAN

SPECIFICATIONS

FOUNDATION: ELEMENT CONC. 1:5:10 USING 40 mm SIZE STONE JELLY 30 CM TK. OVER 15 CM. TK. SAND BED. BRICK MASONRY FOOTINGS IN CM 1:6 MIX.

SUPER-STRUCTURE: BRICK WORK IN CM 1:6 WITH ALL OPENINGS SPANNED BY R.C.C. LINTELS.

ROOF: RCC ROOF SLAB & ALL R.C.C. WORKS ARE IN C.C 1:2:4.

PLASTERING: IN CM 1:5 MIX FOR EXPOSED WALLS IN CM 1:3 MIX FOR CEILING.

FLOORING: BRICK JELLY CEMENT CONC. 1:5:10, 20MM TK. AND TOP FINISHED WITH MOSAIC.

WOOD WORK: WELL SEASONED TEAK/COUNTRY WOOD.

FINISHING: COLOUR CEMENT PAINT TO WALLS & ENAMEL PAINT TO WOOD WORK.

JOINARY DETAILS

D - DOOR 3'-0" x 6'-6" (0.91 x 1.98)
 D1 - DOOR 2'-6" x 6'-6" (0.76 x 1.98)
 W1 - WINDOW 3'-0" x 4'-0" (0.91 x 1.22)
 V - VENTILATOR 2'-6" x 1'-6" (0.76 x 0.45)

COLOUR INDEX

EXISTING ROADS
 PROPOSED SITE BOUNDARY
 TO BE DISMANTLED SEWERAGE LINE

AREA DETAILS

PLOT AREA : 1800 SFT. 167.22 SMT.
 EXISTING CONSTRUCTION : 359.75 " 33.42 "
 PROPOSED CONSTRUCTION : 359.75 " 33.42 "
 PLOT COVERAGE : 40%

PLAN SHOWING THE PROPOSED ADDITIONS TO THE EXISTING RESIDENTIAL BUILDING AT PLOT No. 147, IN PALKALAI NAGAR, MADRAS UNIVERSITY STAFF COLONY, MADRAS - 600 041. Comprised in survey nos. 1 & 80 of Palavakkam village, Saidapet taluk, Chengai M.G.R. District. SCALE - 1"=8'-0" (1:100) ST. THOMAS MOUNT PANCHAYAT UNION.

Planning Permit No. **APPROVED**
 SUBJECT TO THE CONDITIONS IN THIS OFFICE LETTER.
 No. A2/16350/95 Date: 8.9.95
 FOR MEMBER SECRETARY
 MADRAS METROPOLITAN
 DEVELOPMENT AUTHORITY
 MADRAS - 600 008.

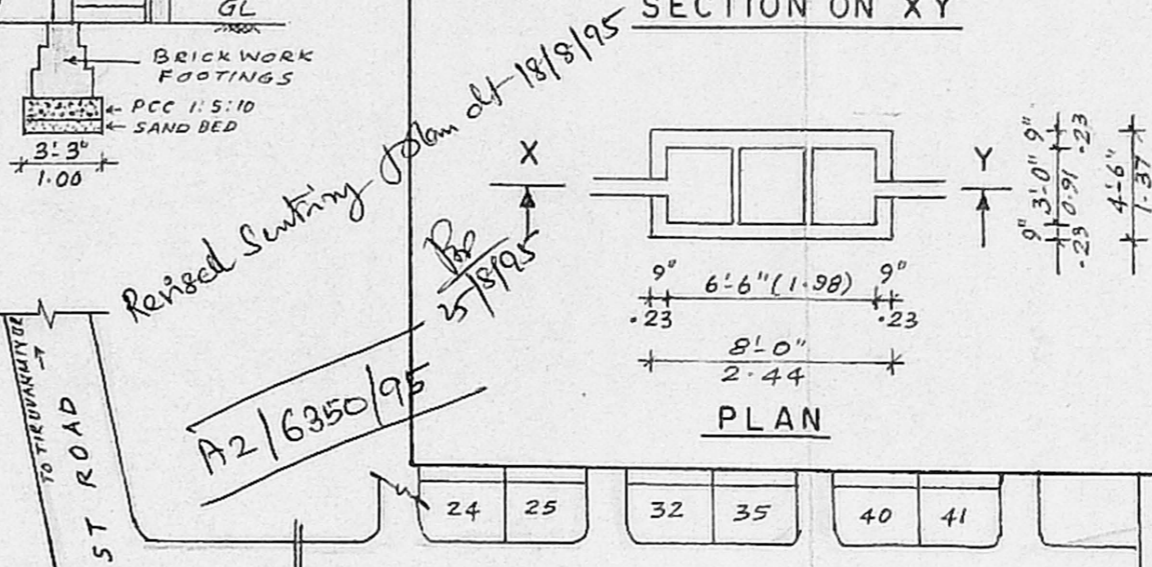

KEY PLAN (NOT TO SCALE)

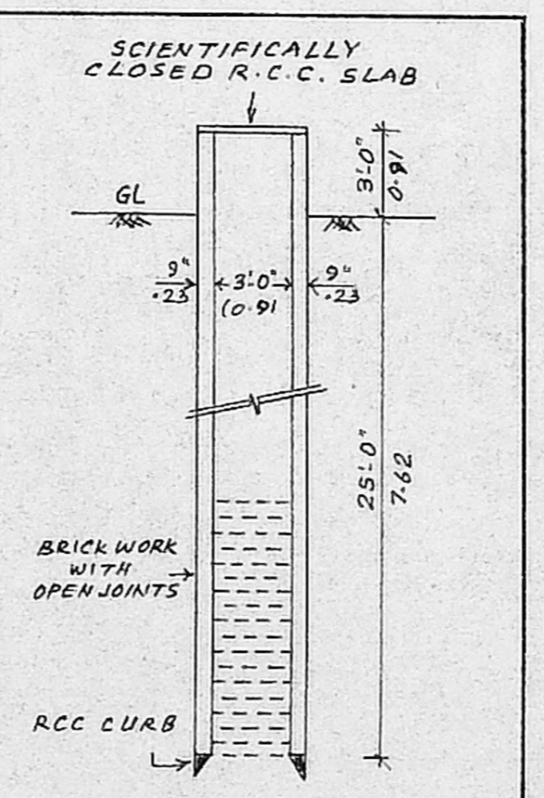

WELL SECTION (NOT TO SCALE)

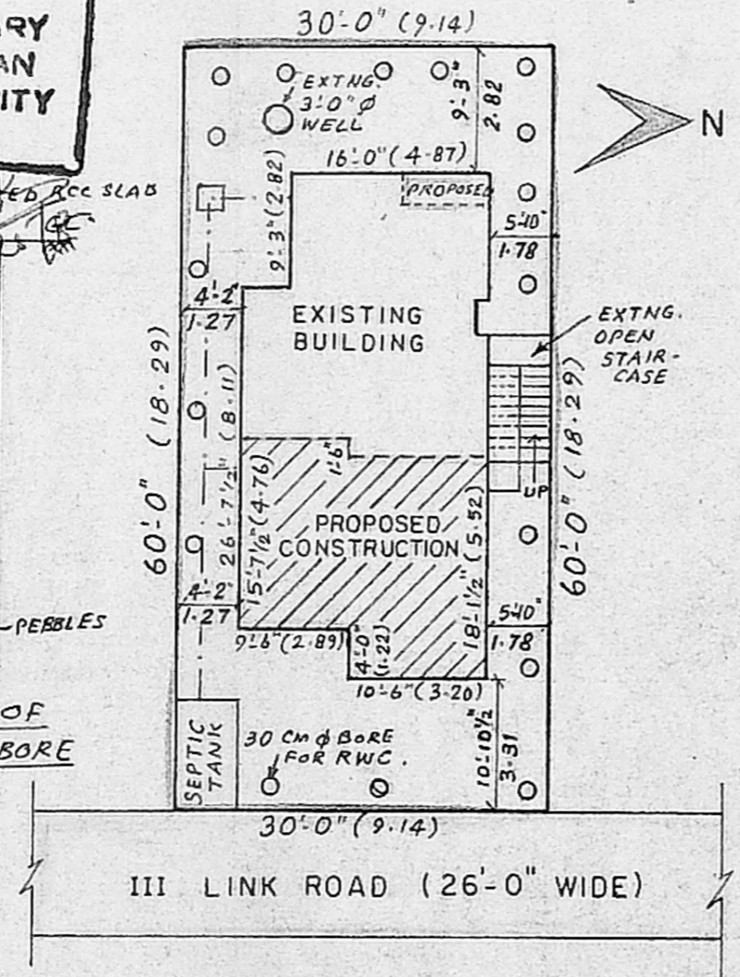

SITE PLAN SCALE - 1" = 16'-0"

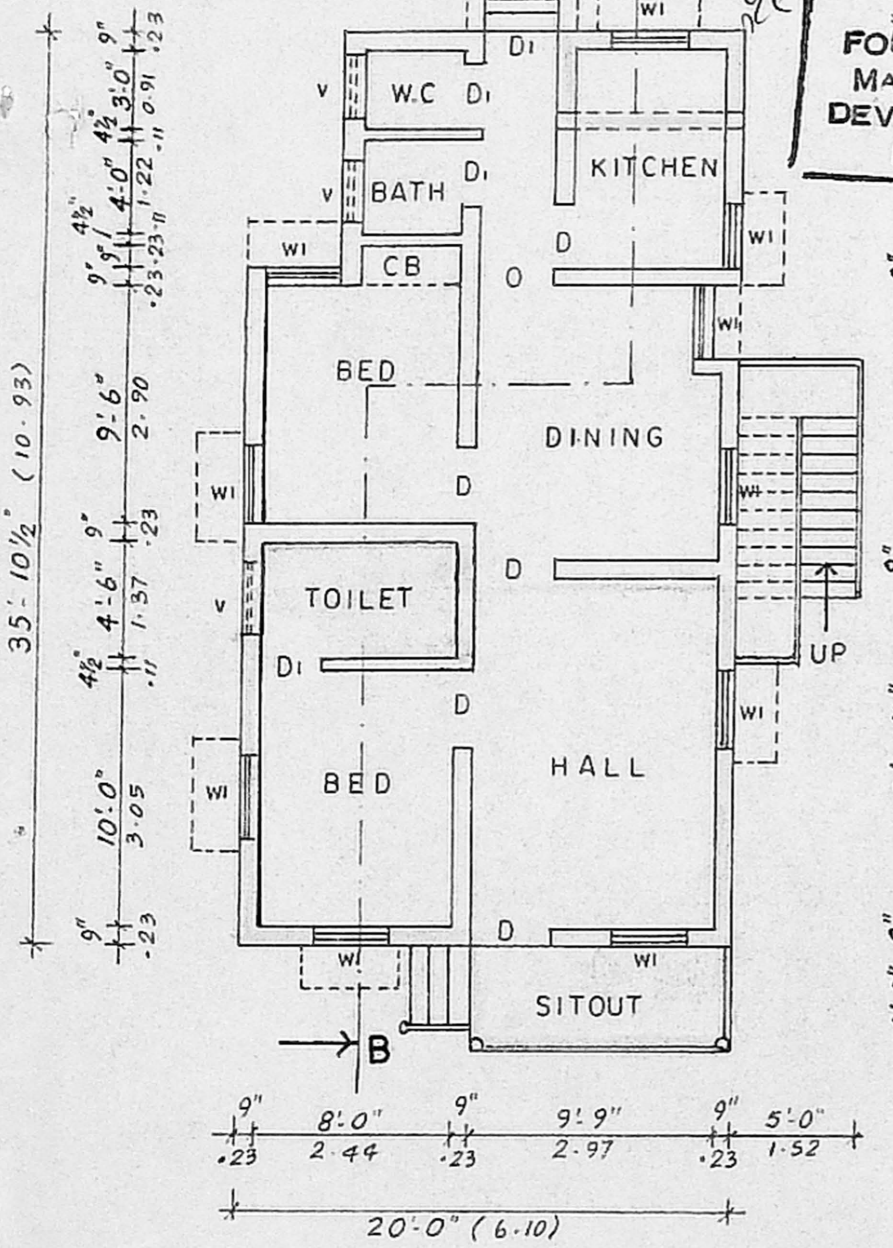

PLAN